

Installation instructions

Suitable for catalogue numbers **WBMRJ11** or **WBMRJ45**

Connection of these data sockets is by insulation displacement (IDC)

Allow 20mm inner cable length for connection

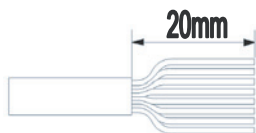

1. Trim cable

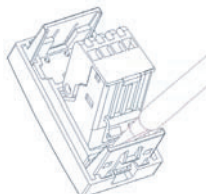

2. Remove jack if required

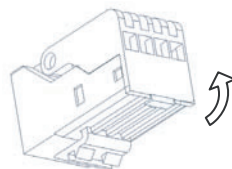

3. Open clear cover

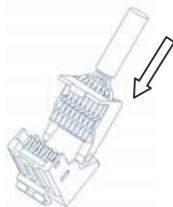

4. Insert cable through cover

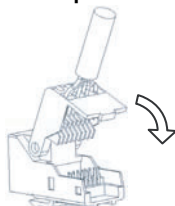

5. Close clear cover

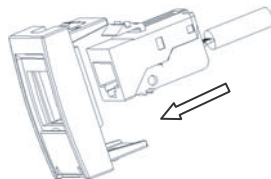

6. Insert jack into the holder and assemble to plate

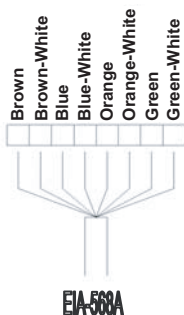

Suitable for **WBMRJ45**

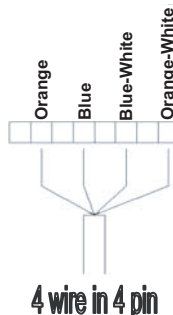
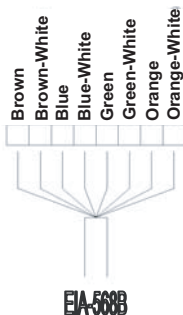

Suitable for **WBMRJ11**

Accomodation plate products

**WBMERJ - No connector
supplied**

**WBMRJ11 - telephone connector
or
WBMRJ45 - data connector**

WBMEBP - Blank plate

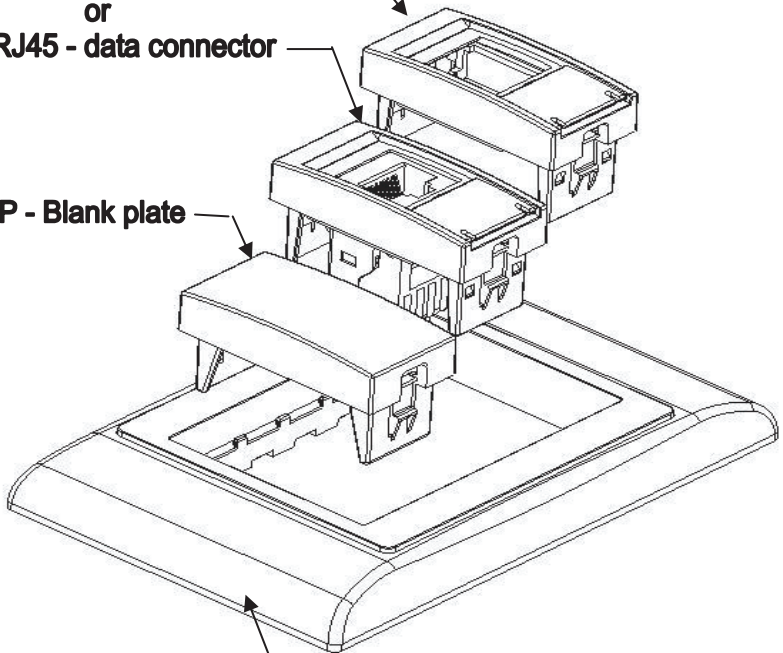

**WBSEA2 - 2 gang plate
or
WBSEA3 - 3 gang plate (shown)**